

REFLECTED CEILING PLAN
SCALE: 1/8" = 1'-0"

CEILING TYPES

1. CEILING HEIGHTS ARE TO BOTTOM OF FINISH PANEL.
2. PROVIDE SEISMIC BRACING FOR SUSPENDED CEILINGS. SEE DETAIL 7/A1.02.

EXIST
 CEILING SUSPENDED CEILING SYSTEM TO REMAIN

CEILING LEGEND

- RELOC 2x4 FLUORESCENT FIXTURE TO BE REMOVED
- EXIST 2x4 FLUORESCENT TO REMAIN
- EXIST SUPPLY DIFFUSER TO REMAIN
- EXIST RETURN GRILLE TO REMAIN
- EXIST EMERGENCY EXIT LIGHT TO REMAIN
- NEW EMERGENCY EXIT LIGHT
- EXIST TRACK LIGHTS TO BE REMOVED

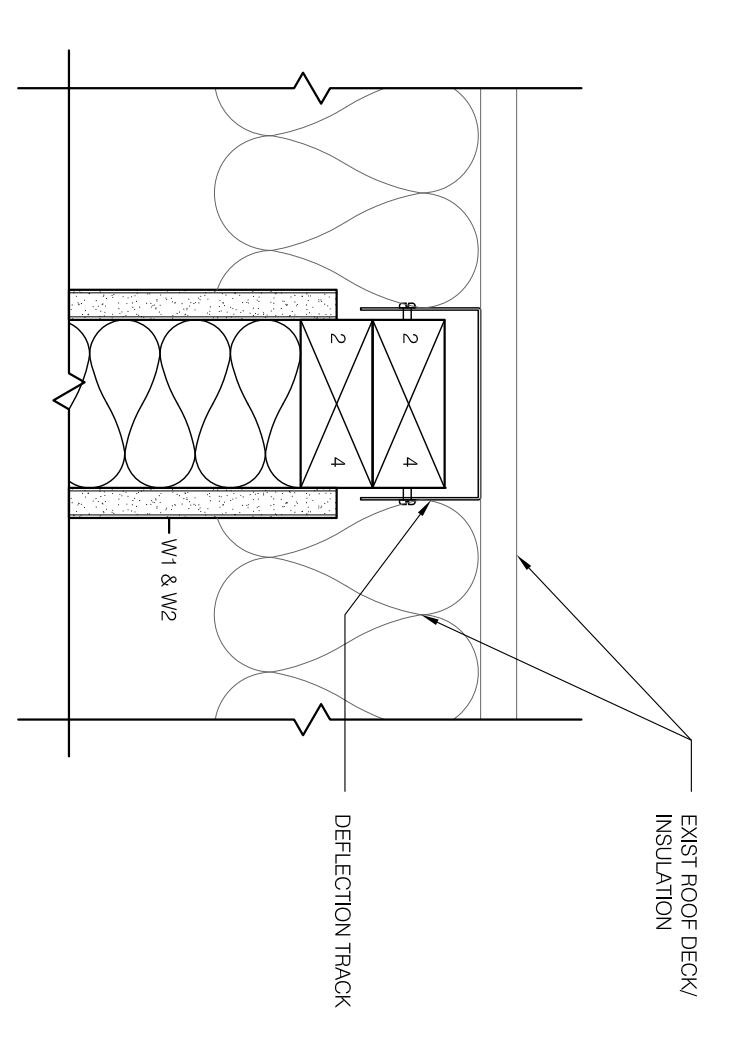

1 | DEFLECTION TRACK
SCALE: 3/8" = 1'-0"

#	REVISIONS	DATE

